

ISS	REVISED BY:	REVISION DATE	ECO #

NOTES:

MATERIAL:

PLATE; STEEL, 36 KSI YIELD

PIPE SHAFT; STEEL, 50 KSI YIELD

WELDING REQUIREMENTS:

ALL WELDING TO BE PERFORMED BY WELDERS  
CERTIFIED UNDER SECTION 5 OF AWS D1.1

FINISH:

HOT DIP GALVANIZED PER ASTM A123

HOT DIP GALVANIZED PER ASTM A153 (HDW)

DIMENSIONS: INCHES

HARDWARE:

HEX HEAD BOLT, 3/4" PER ASTM A325 (2 EA)

MECHANICAL RATING:

ULTIMATE COMPRESSION RATING - 10 KIPS

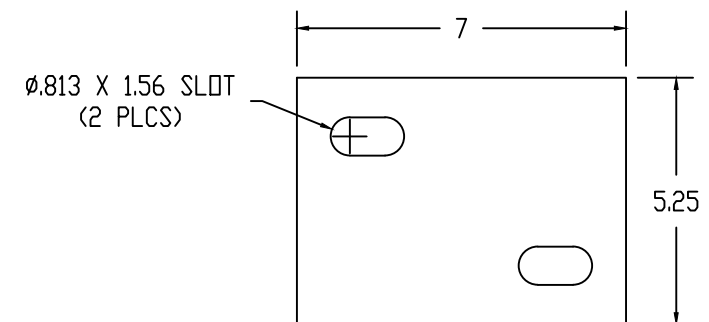
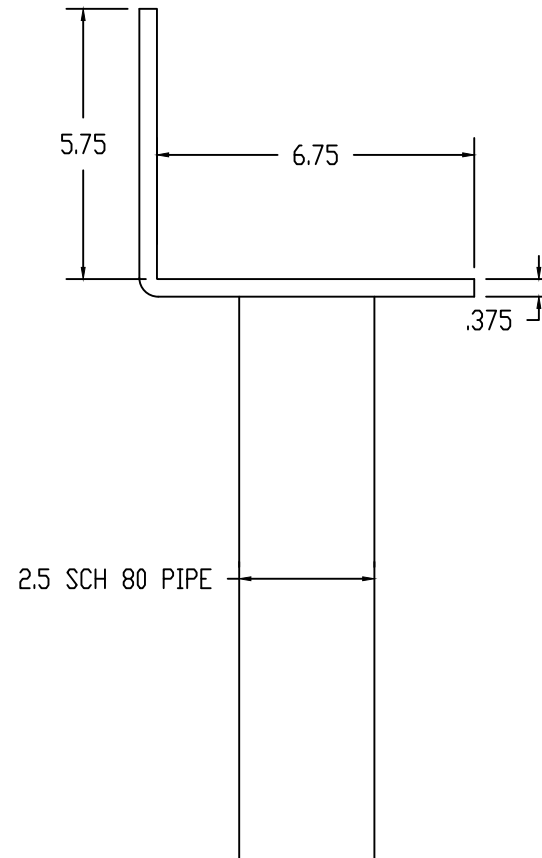
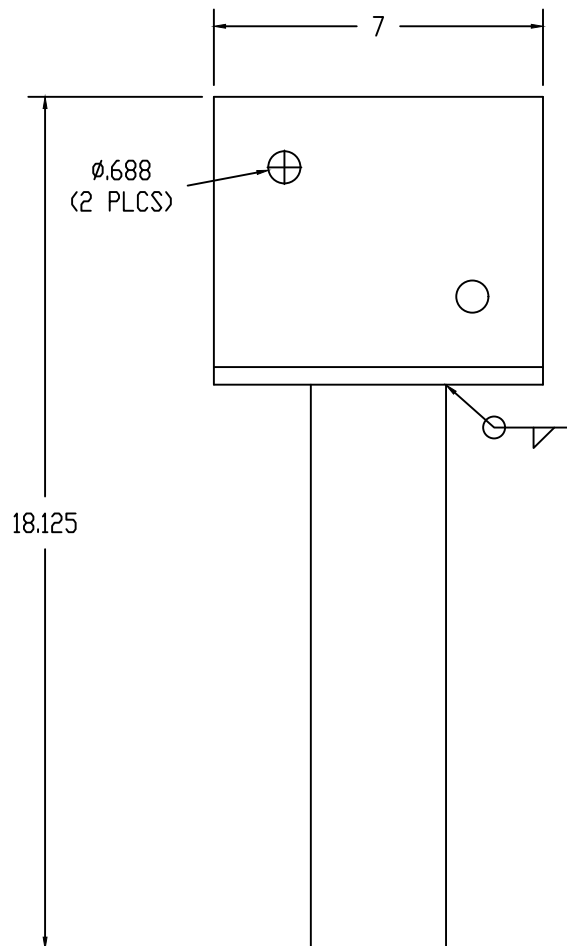

This drawing contains confidential information that is the property of MacLean Power, L.L.C. ("MacLean"). Use of MacLean's confidential information without MacLean's express written consent is strictly prohibited and may expose you to legal liability. If you believe that you received this material in error, please destroy it or return it to MacLean Power, L.L.C., Kingsley Park Five, 481 Munn Rd. Suite 300, Fort Mill, SC 29715, USA.



WWW.MACLEANPOWER.COM

CATALOG NUMBER:			N-6401-0211
SHEET NAME:		Sheet1	1 OF 1
DRAWING DESCRIPTION:			
D6/D7 BEAM SADDLE BRACKET			
DRAWN BY:	DH	DATE:	10/12/20
APPROVED:	DR		